



PRECISION **R**OTATING **E**QUIPMENT

CUSTOM EQUIPMENT FOR THE WATER AND WASTEWATER TREATMENT INDUSTRY

Bridge Mounted Dual Shaft Drives



PRE Bridge Mounted Dual Shaft Drives



FEATURES

- ◆ Precision main gears and bearings allow for a more robust drive unit as opposed to cast iron strip liner drives, which can have inclusions that will weaken the gearing and housing. Design life for PRE Drives is a calculated L10 life in excess of 100 years as the standard.
- ◆ Hydraulic torque control, measured by the reaction of the rotation of the upper gear housing, offers a more accurate measurement of torque, along with eliminating the use of worm gears or mechanical overload devices, which can both seize up over time.
- ◆ Planetary and Helical speed reducers allow for high efficiency designs, which in turn can reduce power consumption, thus saving the plant money in electricity costs.
- ◆ Direct coupled components eliminate the use of chains and sprockets, which makes maintenance of your drive unit simpler.
- ◆ Elimination of the use of a lower pinion bearing, which is a common failure point in competitors' drive units.
- ◆ Drive units can be provided with torques in excess of 1 million foot-pounds of continuous torque.
- ◆ Available On-site, Turnkey Inspection, Repair, and Replacement Services. Standard components save time and money.



DRIVE DESCRIPTION

- ◆ High torque / low speed, direct coupled gear drive.
- ◆ Totally encased with oil bath.
- ◆ Integrated Precision Bearing / Gear
- ◆ The Drive mounts to the access bridge.
- ◆ Design suitable for clarifiers or thickeners in municipal, industrial, power, pulp and paper, mining, others.
- ◆ Designed for a wide range of torque values and tank sizes.

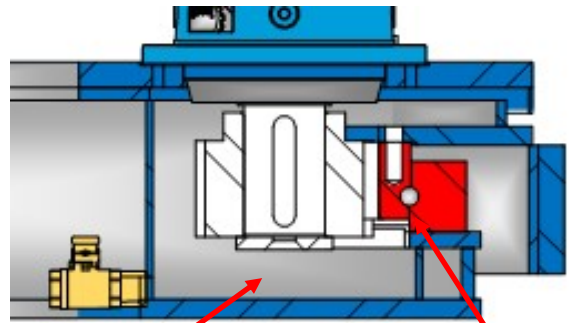

**Condensate
Collection**

**Precision
Bearing**

No Lower Bearing Required

Moment Arm is all but eliminated plus the Reducer has a 1.25 service factor to handle radial loads.



**Water & Wastewater
Treatment Solutions**
Municipal & Industrial

9090 South 300 West
Sandy, UT 84070
Phone (801) 949-2083 | Fax (801) 676-1893
www.premfg.net

Bridge Mounted Dual Shaft Drives

TORQUE CAPACITY					
GEAR DIA.	MODEL	CONTINUOUS*		DUTY RATED**	
		Ft Lbs	N-m	Ft Lbs	N-m
25 DUAL SHAFT	SD25-A	6,000	8,200	18,000	24,600
	SD25-B	8,500	11,600	21,250	29,380
	SD25-C	12,000	16,400	30,000	41,000
	SD25-D	16,000	21,865	40,000	54,665
43 DUAL SHAFT	SD43-A	17,500	23,900	43,750	59,790
	SD43-B	25,500	34,850	63,750	87,125
	SD43-C	35,000	47,500	87,500	119,580
	SD43-D	42,500	58,080	106,250	145,200
	SD43-E	51,000	69,000	127,500	174,250
54 DUAL SHAFT	SD54-A	60,000	82,000	150,000	205,000
	SD54-B	70,000	95,000	175,000	239,665
	SD54-C	87,000	118,900	217,500	297,250
61 DUAL SHAFT	SD61-A	100,000	136,665	250,000	339,000
	SD61-B	120,000	154,000	300,000	410,000
	SD61-C	140,000	191,330	350,000	478,330
	SD61-D	160,000	218,665	400,000	546,665
61 DUAL PINION DUAL SHAFT	SD2P61-A	200,000	273,330	500,000	678,000
	SD2P61-B	320,000	437,330	800,000	1,093,330
80 (2) PINION DS	SD2P80-A	500,000	678,000	1,250,000	1,708,330
80 (4) PINION DS	SD4P80-B	1,000,000	1,366,665	2,500,000	3,416,665

* **Continuous:** Torque at which the drive main gear will have a life in excess of 20 years when operating at rated speeds.

****Duty Rated:** The maximum allowable, momentary torque to prevent component failure.

Note: Consistently operating at this torque (or any percentage above Continuous torque) will exponentially reduce the lifetime of drive components.

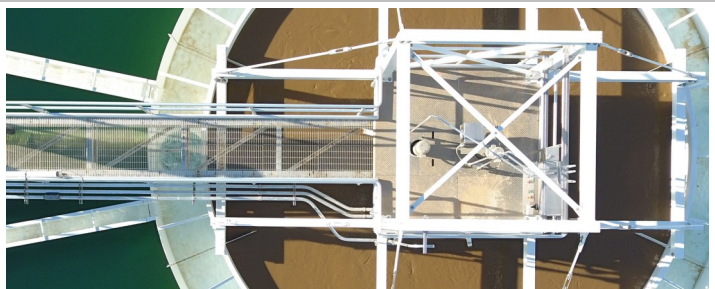

PRE Bridge Mounted Dual Shaft Drives

PART DESCRIPTION	
ITEM NO.	PART NAME
1	PRIMARY REDUCER (RAKE)
2	TORQUE BOX (RAKE)
3	SECONDARY REDUCER (RAKE)
4	OUTPUT SHAFT (TURBINE)
5	COVER
6	UPPER BASE (RAKE)
7	PRIMARY REDUCER (TURBINE)
8	LOWER BASE (TURBINE)
9	OUTPUT SHAFT (RAKE)
10	MAIN GEAR OIL FILL CAP (RAKE)
11	OIL EXPANSION / FILL
12	MAIN GEAR OIL FILL CAP (TURBINE)

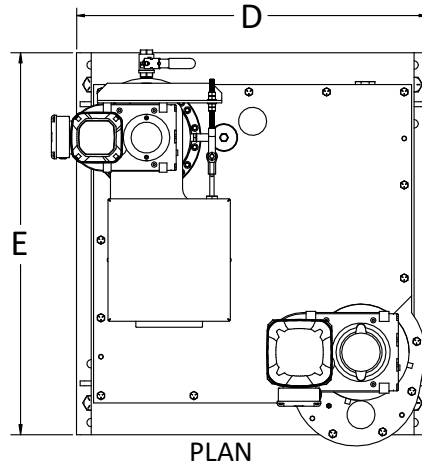
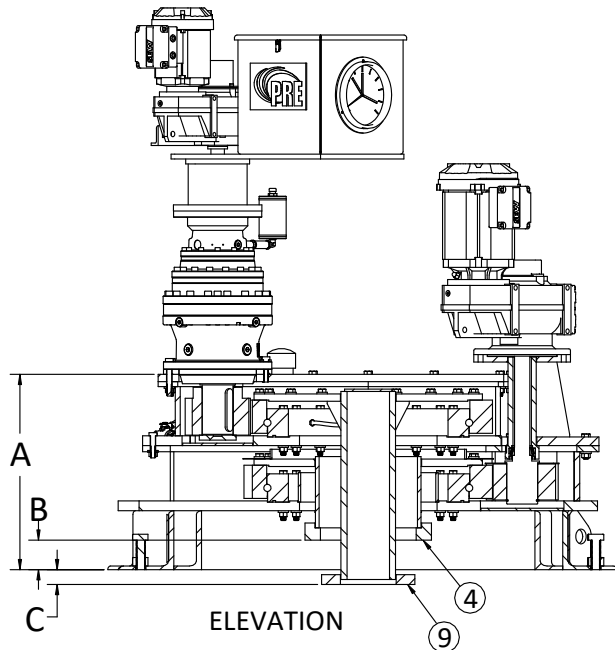
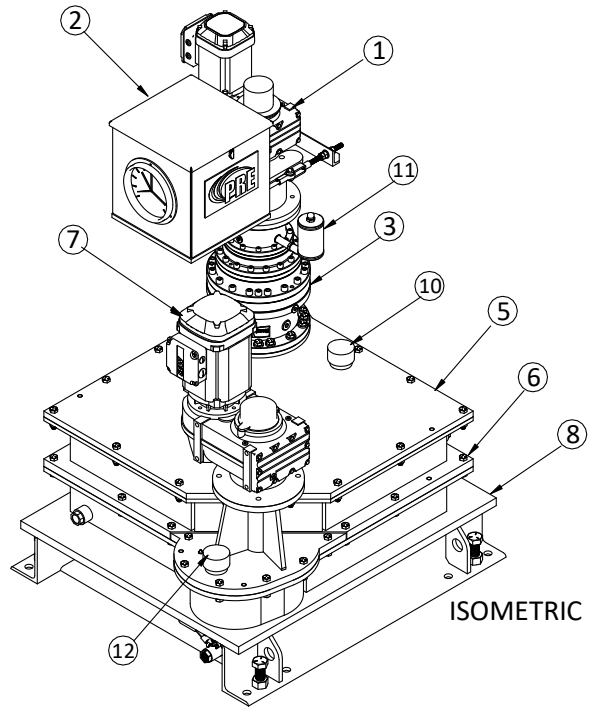

Model	A		B		C		D		E		Weight	
	Inches	mm	Inches	mm	Inches	mm	Inches	mm	Inches	mm	lbs	kg
SD25	19 7/8	505	3	76	1 1/2	38	36	914	39	991	2,400	1,089
SD43	18 3/4	476	- 3*	-76	9	229	58	1473	53 1/4	1353	4,500	2,041
SD54	25 1/4	641	-6 1/2*	-165	12 1/2	318	70	1778	78	1981	6,300	2,858
SD61	31	787	- 8*	-203	14 1/4	362	81	2057	89	2261	9,200	4,173
SD80	39	991	-9 1/4*	-235	16	406	107	2718	107	2972	14,000	6,350

* THE FLANGE IS BELOW THE MOUNTING SURFACE



Water & Wastewater
Treatment Solutions
Municipal & Industrial

9090 South 300 West
Sandy, UT 84070
Phone (801) 949-2083 | Fax (801) 676-1893
www.premfg.net